



Spadina Station (Line 1) Easier Access Program Update

Public Presentation

September 2025

Easier Access Program

- TTC's Advisory Committee on Accessible Transit (ACAT) has a critical role in making TTC accessible.
- Comprised of volunteers, ACAT helps TTC design and implement the Easier Access Programs through the lens of persons with disabilities and seniors.
- 58 of 70 subway stations are now accessible.
- Easier Access projects continue at the following stations:
 - **Spadina**, Rosedale, Christie, Warden, Summerhill, Greenwood, Islington, Lawrence, College, Museum, King, and Old Mill

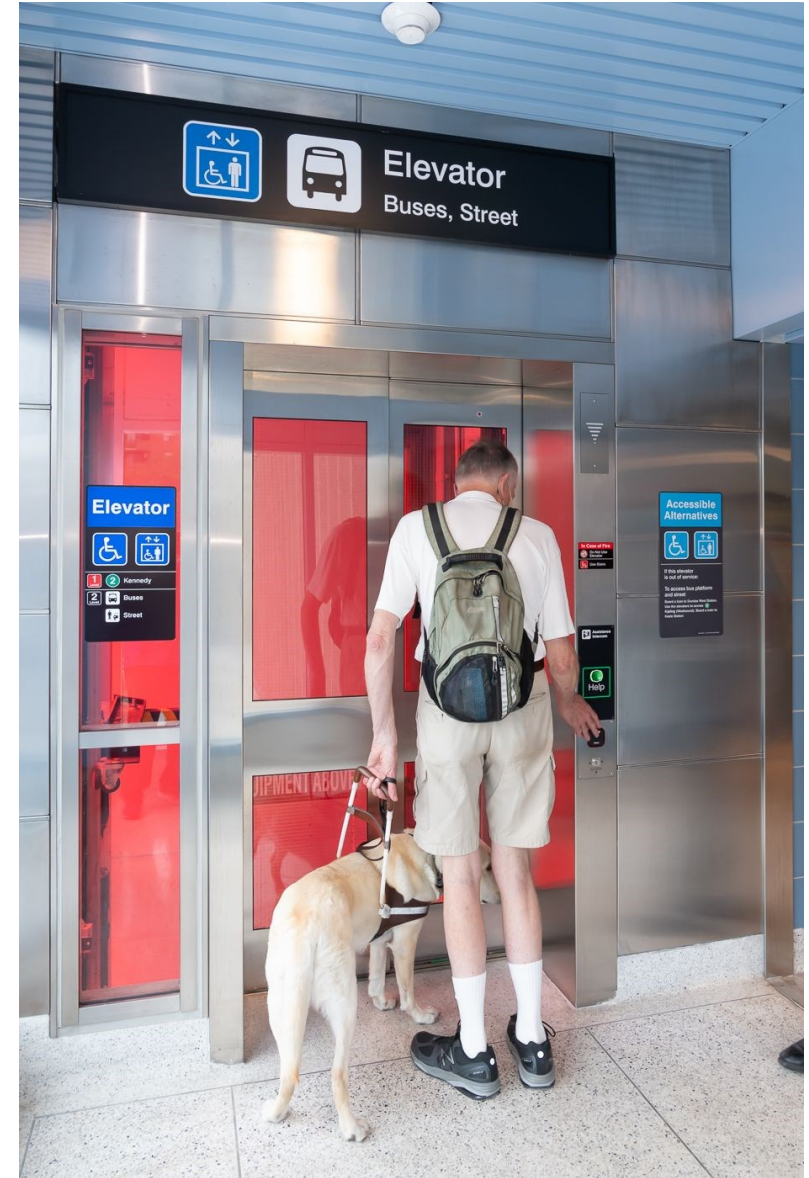

| Spadina Station Easier Access

Easier Access Improvements

Barrier-free path between Line 1 platform and the underground pedestrian walkway, which leads to Spadina Station Line 2, the streetcar platform, the bus terminal and the street-level entrances/exits.

- Two new elevators.
- PRESTO-enabled accessible fare gates (installed).
- Improved signage.
- CCTV – Security cameras inside of the station.

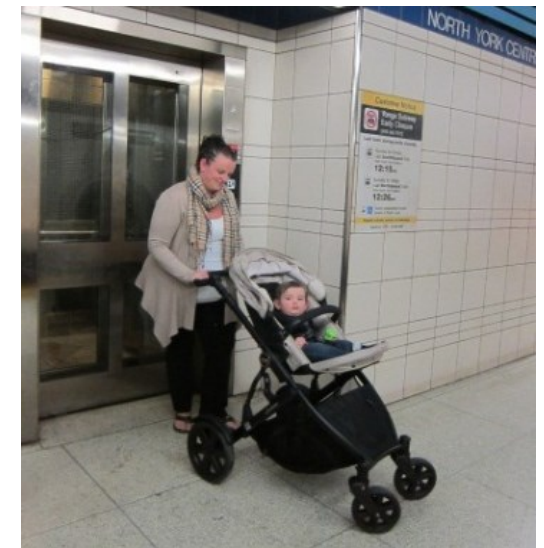

Project Site

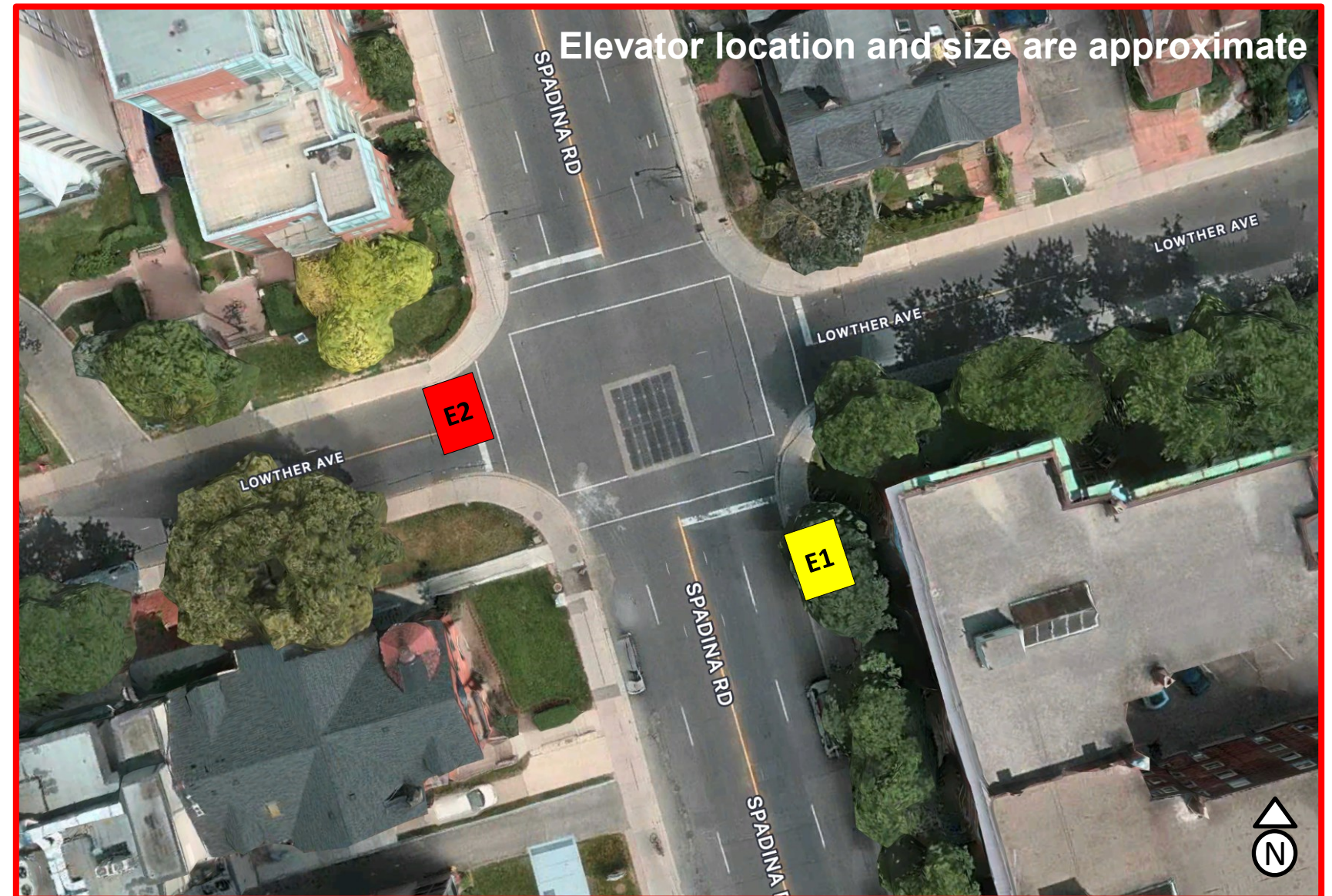
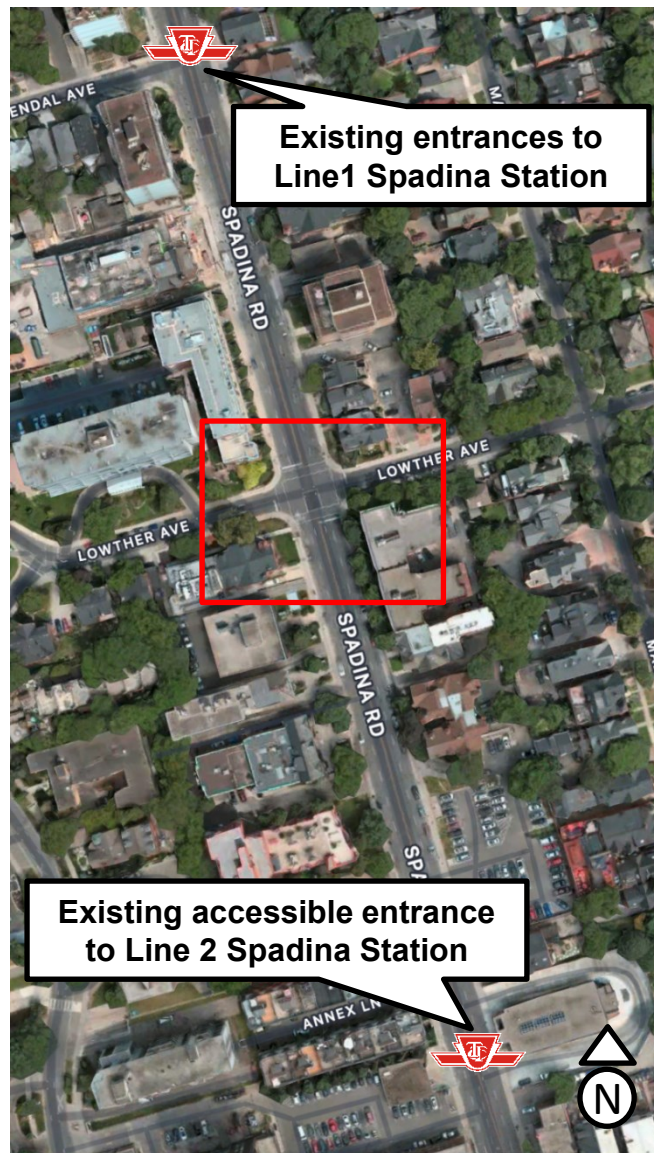

Spadina Station Elevation Plan

2 Spadina Station (Bloor-Danforth)

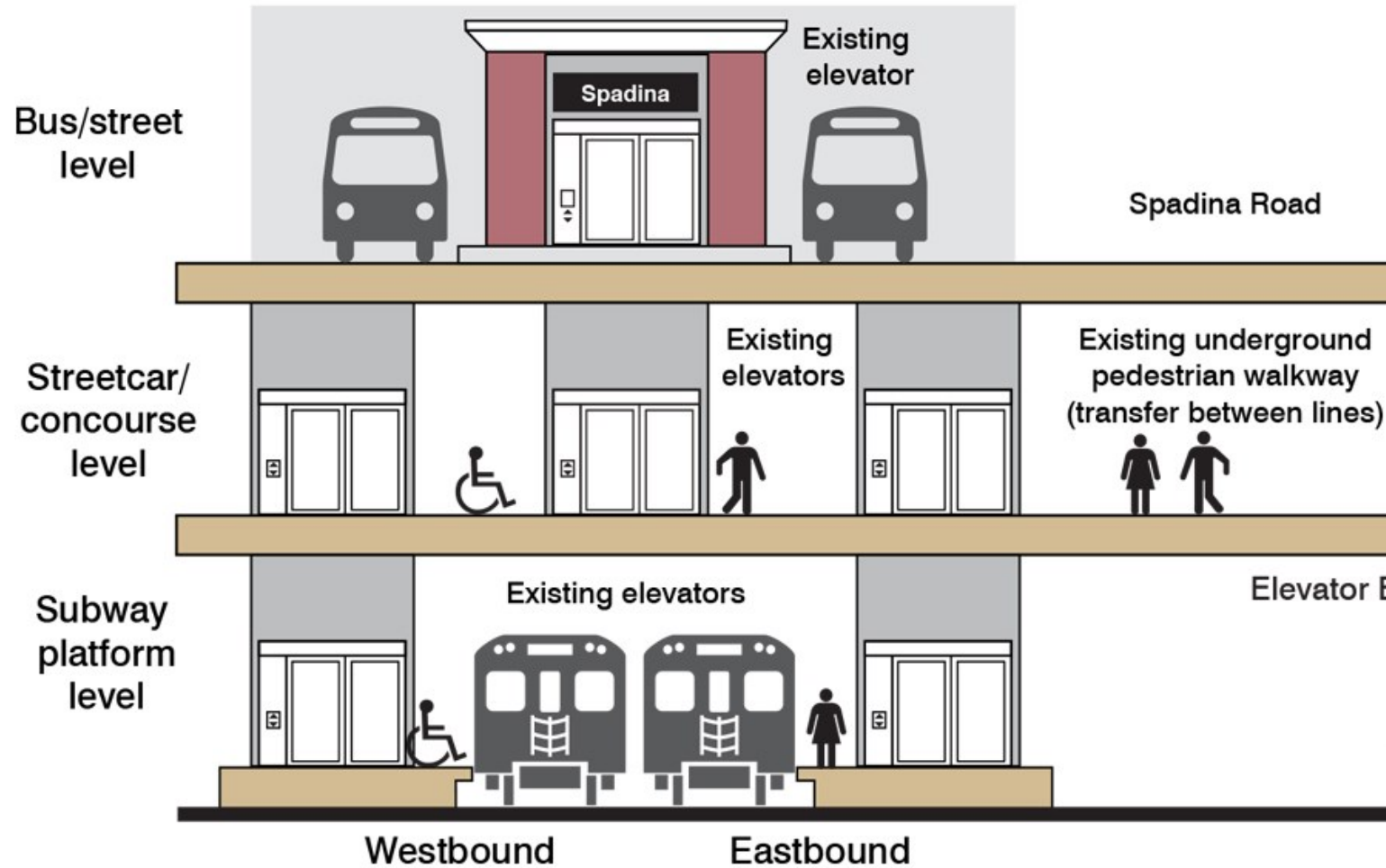

No new elevator structure or entrance at street level for Spadina Station Easier Access

1 Spadina Station (Yonge-University)

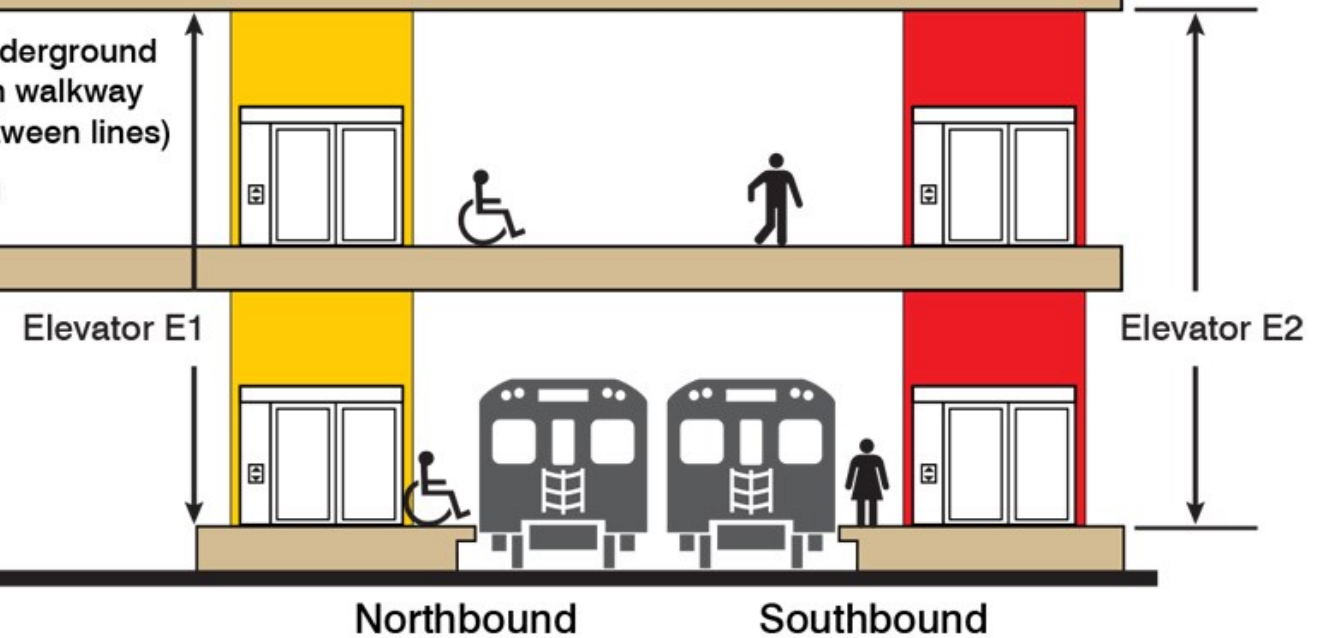

Concourse Level Floor Plan

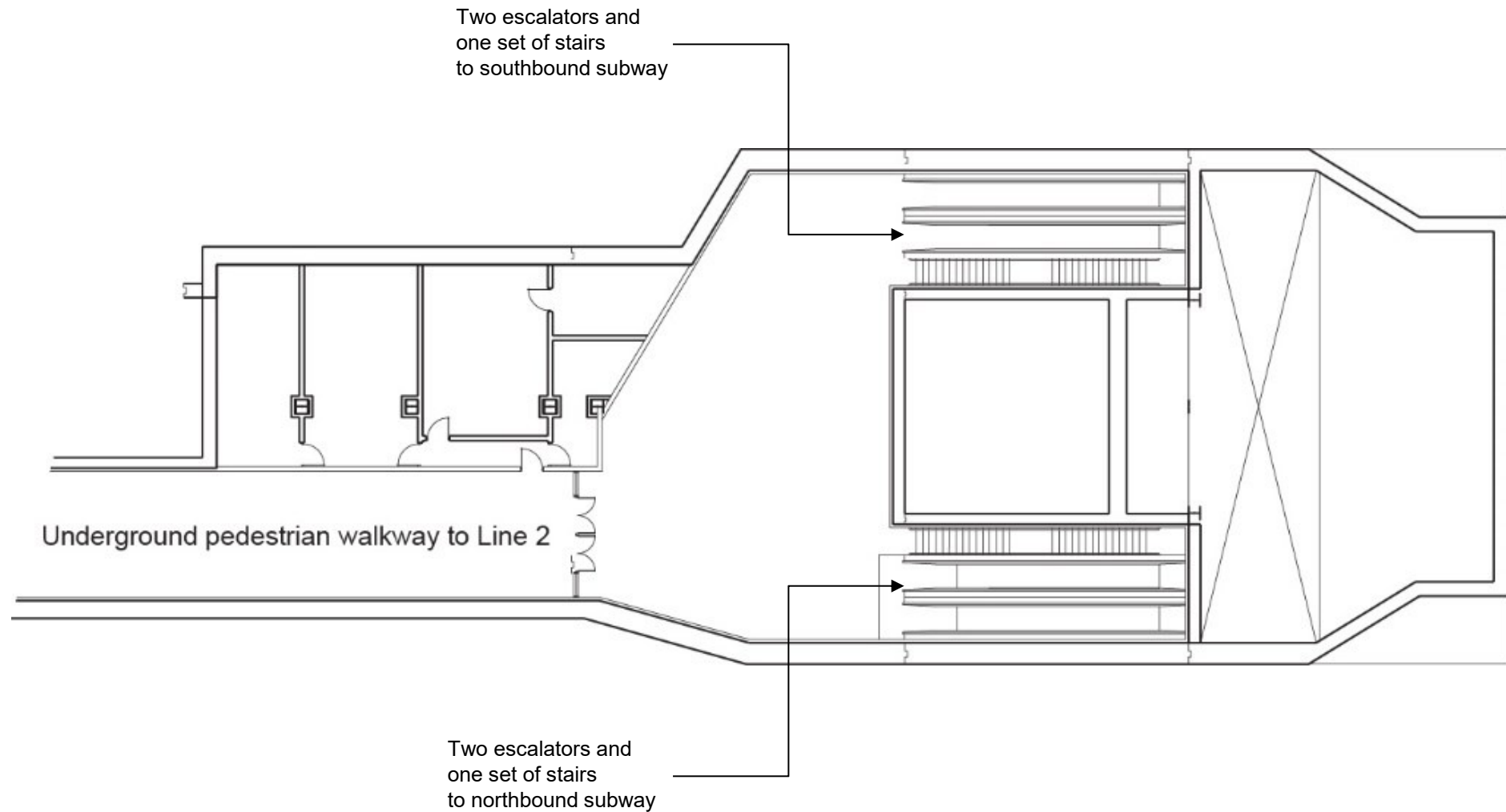

Concourse Level: Post-Construction

Three of the four escalators are being permanently removed.
One escalator will remain on the southbound platform.

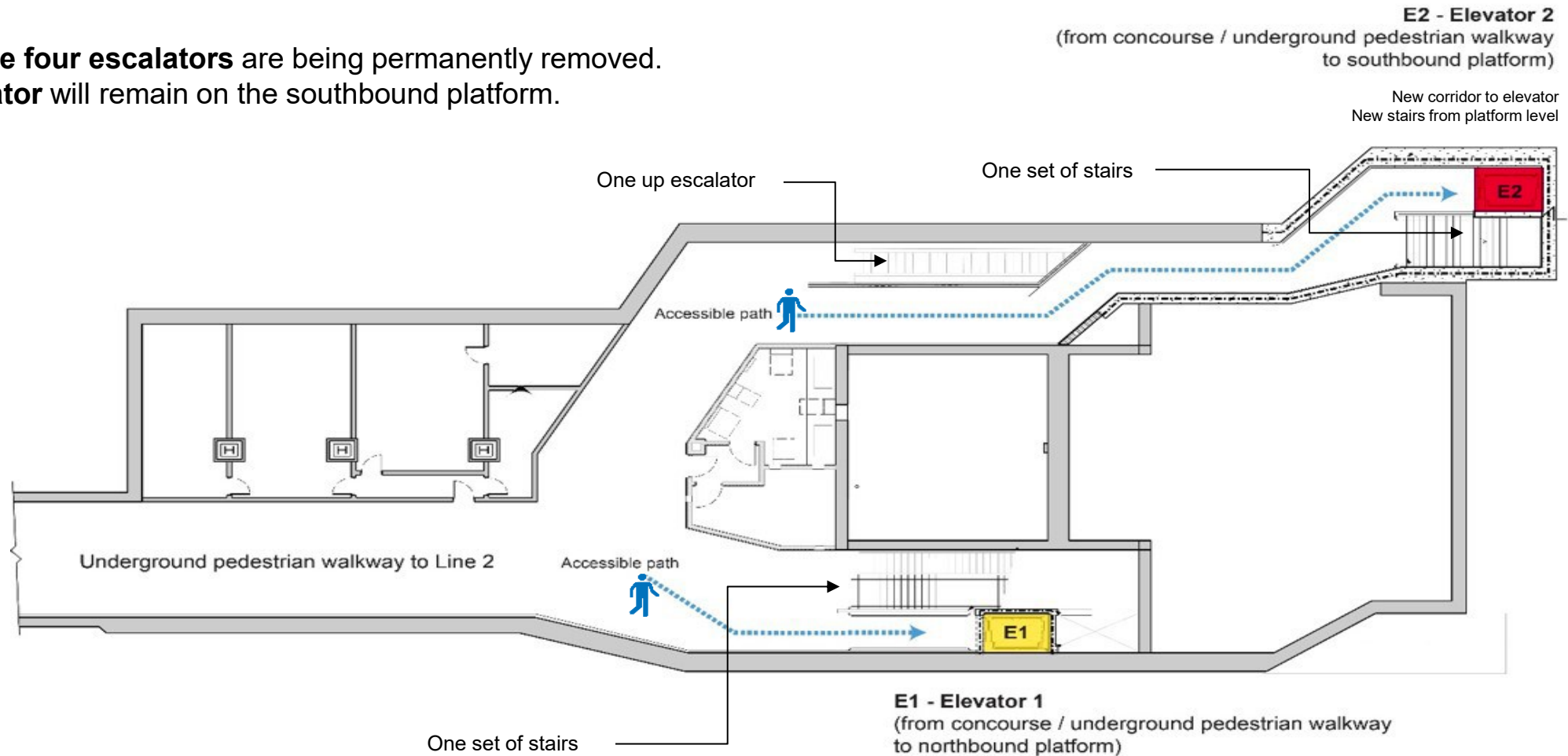

| Platform Level Floor Plan

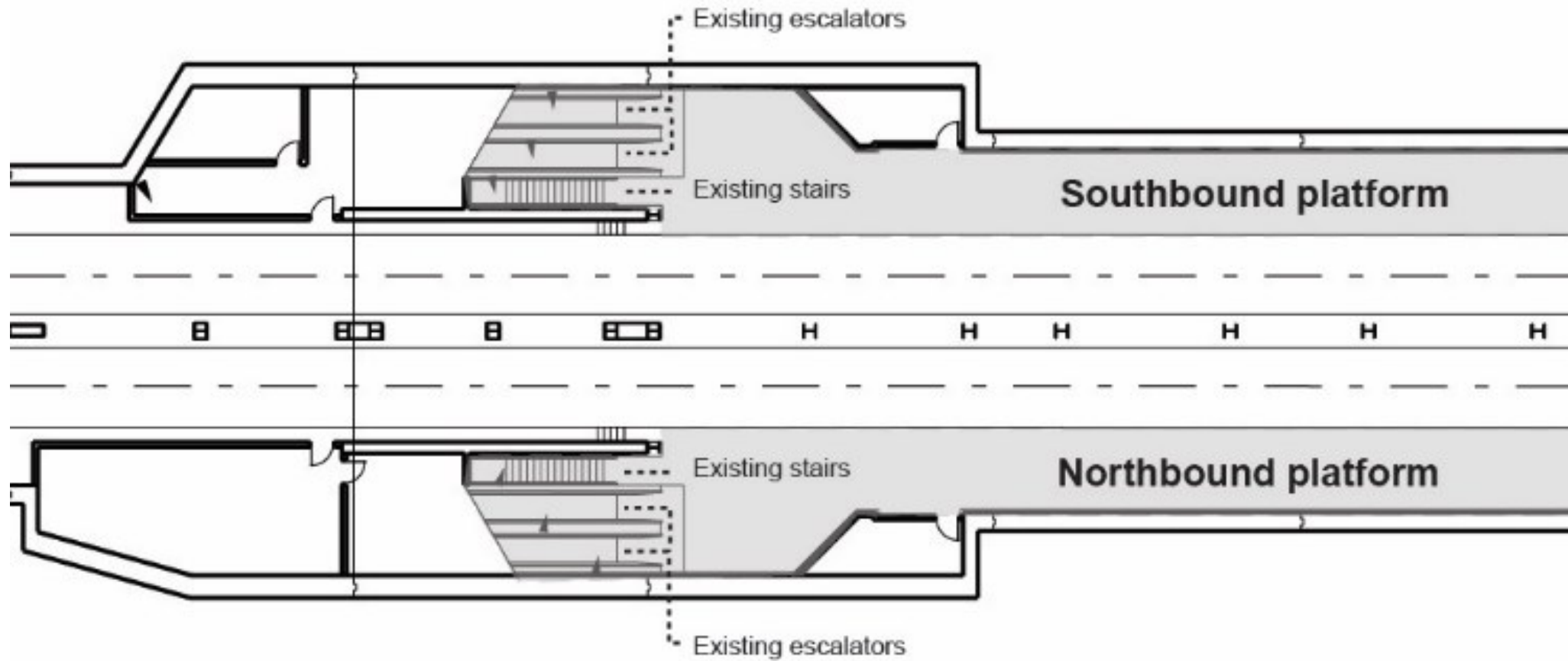

Platform Level: Post-Construction

Three of the four escalators are being permanently removed.
One escalator will remain on the southbound platform.

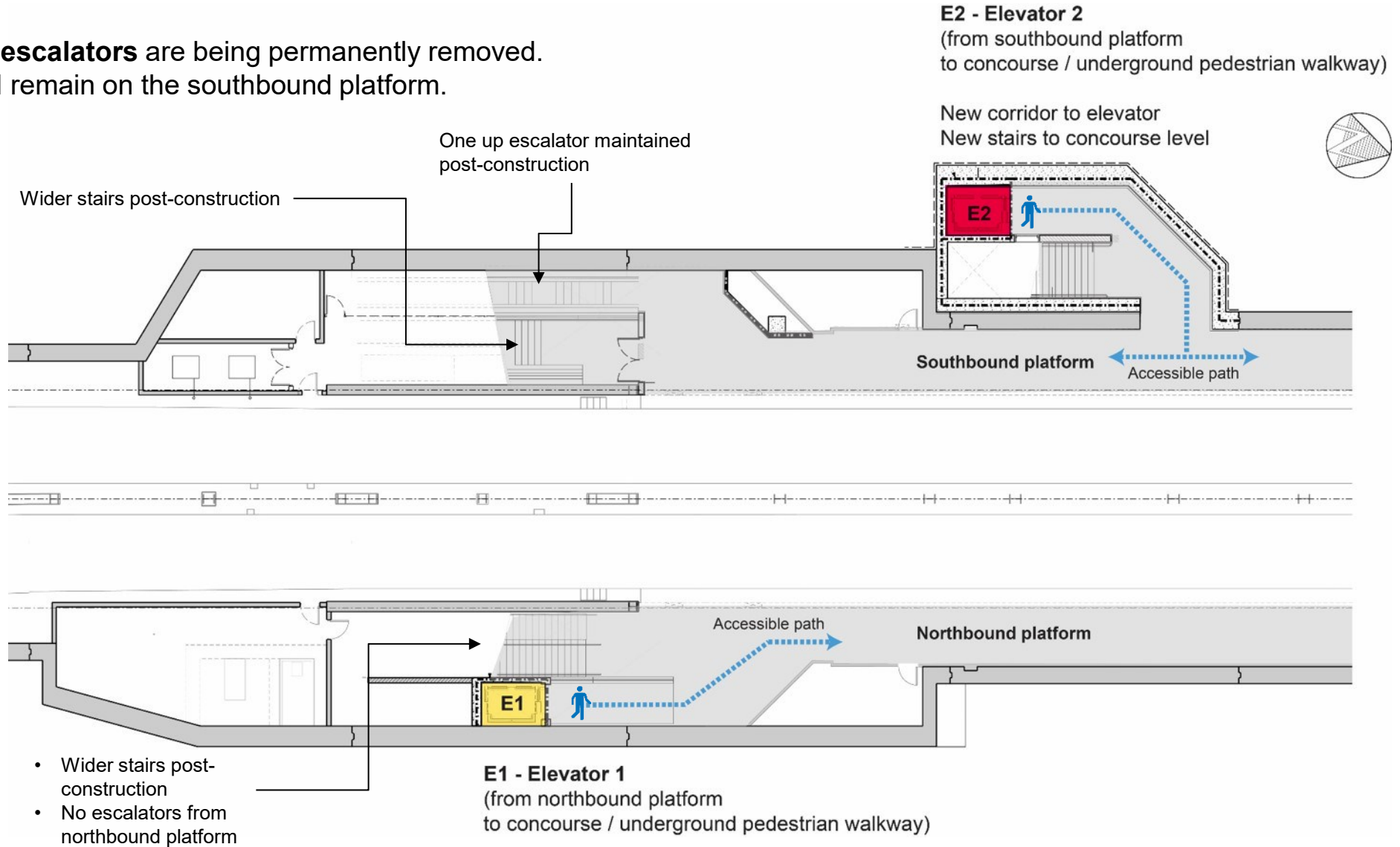

| Phases and Staging

- The construction is at Spadina Rd and Lowther Ave at street level and near the pedestrian walkway where it meets Line 1.
- Two-phase construction project with overlapping timelines:
 - Phase 1: Utility relocations west of Spadina Rd will be completed first, followed by construction of elevator 2 (E2) west of Spadina Rd. Once construction west of Spadina Rd is complete, the area will be restored.
 - Phase 2: Construction of elevator 1 (E1) east of Spadina Rd will be completed, and the area will be restored.
 - Concurrent work inside the station for both phases.

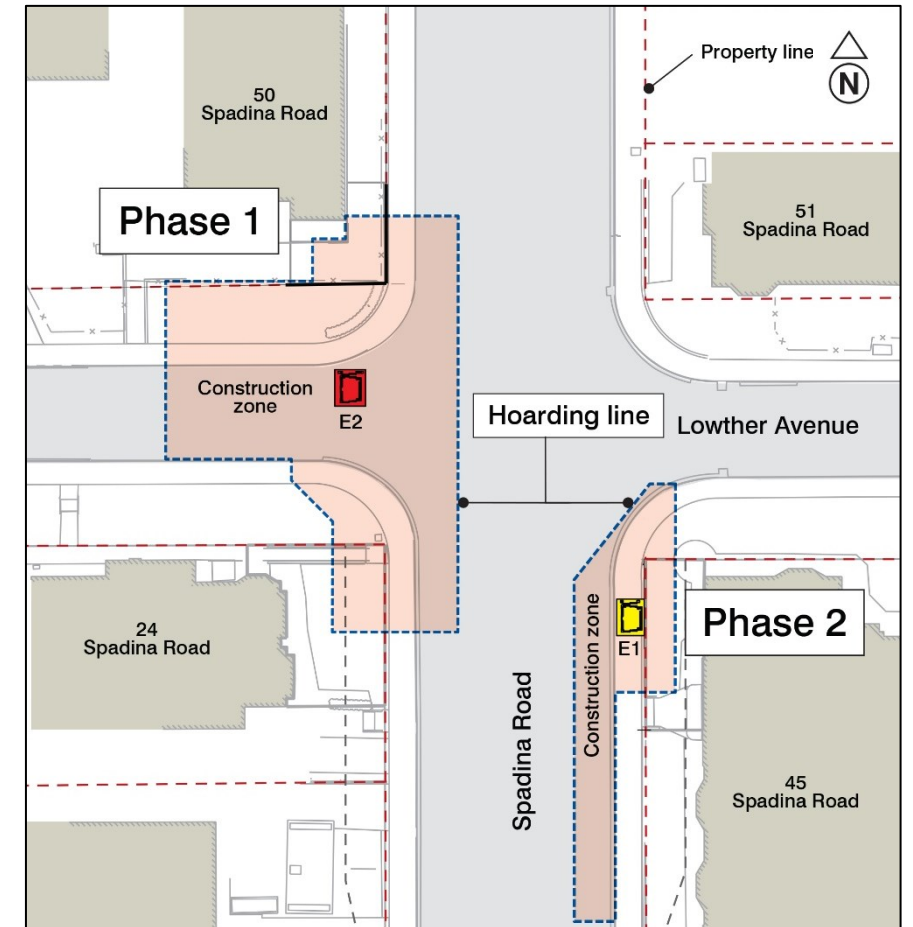

| Phase 1 (Street Level)

Timeline: Summer 2022 to Fall 2025*

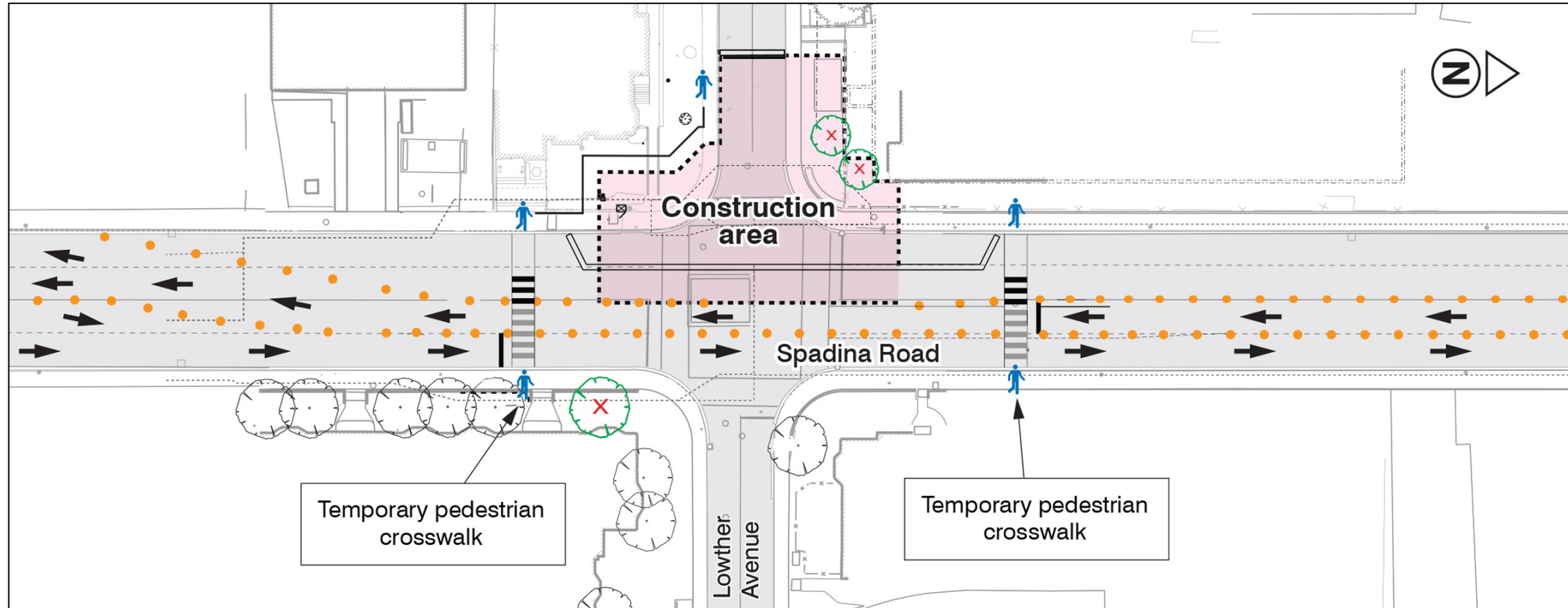

Traffic lane restrictions: one northbound lane and one southbound lane remain open

**subject to weather and unforeseen events/circumstances; content/timeline accurate at time of communication*

| Phase 1 (Street Level)

Timeline: Summer 2022 to Fall 2025*

- Construction work for E2 on Lowther Ave, on the west side of Spadina Rd, including utility investigations, utility relocations, caisson work, excavation, and building of structures.
- Traffic lane restrictions: one northbound lane and one southbound lane to remain open.
- Temporary road closures: Lowther Ave west of Spadina Rd, Lowther Ave east of Spadina Rd, and nightly closure of Spadina Rd at Lowther Ave.
- New and temporary controlled pedestrian crosswalks north and south of the construction site.
- Bus stop(s) at Spadina Rd and Lowther Ave are out of service at various points during construction and bus route diversion during the nightly closure.

**subject to weather and unforeseen events/circumstances; content/timeline accurate at time of communication*



| Phase 2 (Street Level)

Timeline: Fall 2025 to Summer 2026*

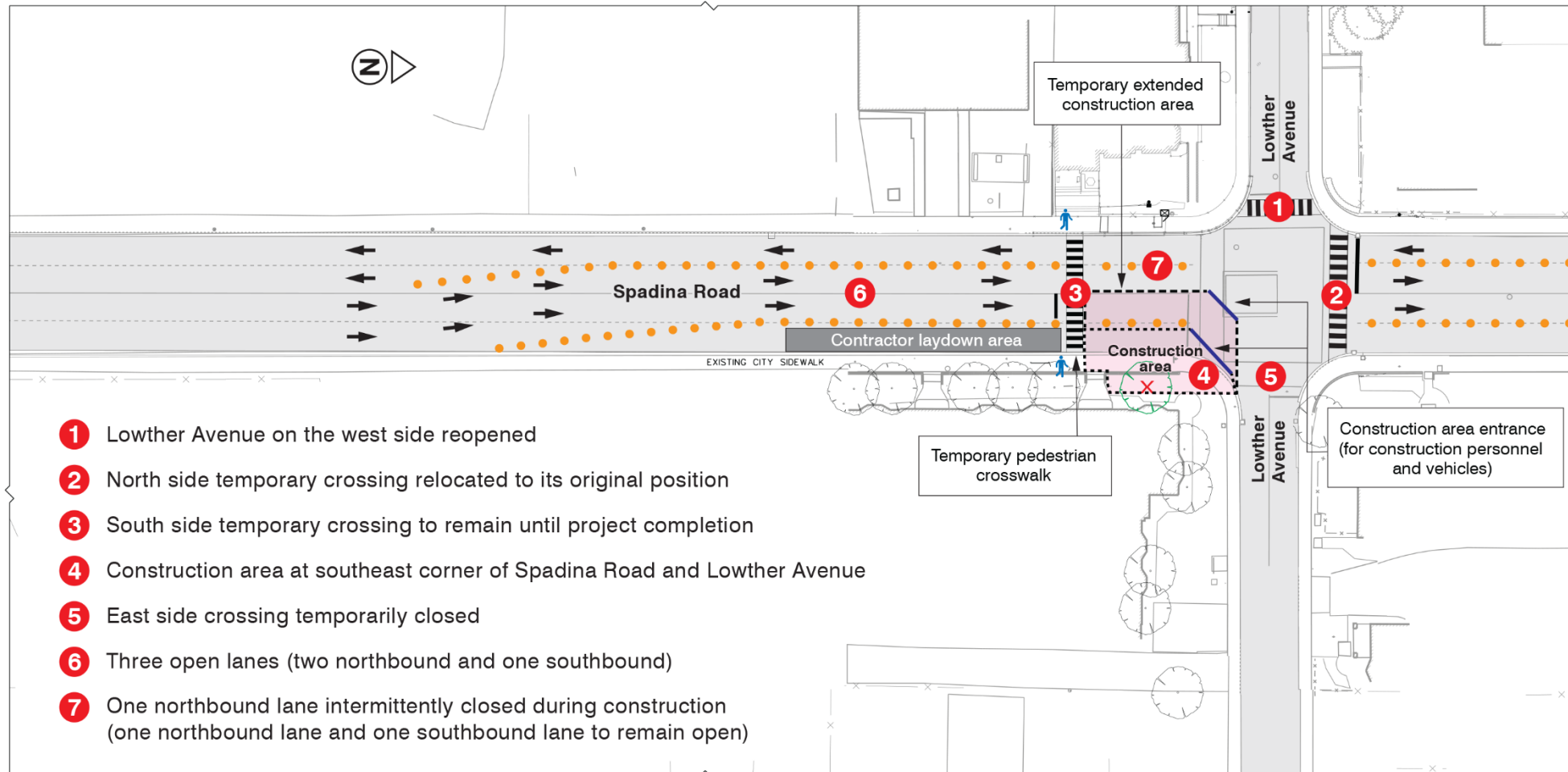

**subject to weather and unforeseen events/circumstances; content/timeline accurate at time of communication*

| Phase 2 (Street Level)

Timeline: Fall 2025 to Summer 2026*

- Construction work for Elevator 1 (E1) will be on the southeast corner of Spadina Road / south side of Lowther Avenue, including caisson work, excavation, and building of structures.
- Lowther Avenue will be reopened on the west side of Spadina Road.
- The original north crosswalk will be reinstated, as the north temporary crosswalk will be removed. The south temporary crosswalk will remain until the project is completed.
- The east side pedestrian crossing will be temporarily closed; pedestrians can cross at the next closest pedestrian crossing.
- Three lanes are expected to be open on Spadina Road (two northbound and one southbound), but intermittently, two lanes will be open (one northbound and one southbound) at various points throughout the construction.
- Bus stop(s) at Spadina Road and Lowther Avenue will be out of service at various points during construction.

**subject to weather and unforeseen events/circumstances; content/timeline accurate at time of communication*



| Impacts

Street Level

- Traffic on Spadina Rd is maintained with lane restrictions during both phases.
- Sidewalk closures/detours required.
- Exit/entrance of Lowther Ave west of Spadina Rd closed to traffic for Phase 1.
- Noise, vibration, and dust are expected from this construction.
- Bus stop(s) at the intersection of Spadina Rd and Lowther Ave are temporarily affected.

Inside the Station

- Permanent removal of three escalators and one escalator temporarily taken out of service during construction.

| Construction Details and Transit Information

- Major construction activities include utility relocations, shoring, and excavation of elevator shafts to the subway platform level.
- Construction work is expected to occur Monday to Friday between 7 a.m. and 7 p.m. Some work on weekends and overnight may be required.
- Noise, dust, and vibration associated with construction are unavoidable with this work.
- Access to Spadina Station will be uninterrupted by this construction. No impacts to subway or streetcar services. Bus service interruptions are expected as noted above.



| Public Art

- As with all Easier Access projects, Spadina Station will receive public art in accordance with TTC's Public Art Policy.
- Art to be installed at Spadina Station upon project completion.
- Details to be confirmed.



| More Information

For any questions/comments or to be added to the project email list:

Website: www.ttc.ca/SpadinaConstruction

Contact: Reka Sivarajah, Senior Community Liaison
437-994-6317 | Reka.Sivarajah@ttc.ca

